



Data Sheet

Optima 450 LED® Edge-Lit Light Box



General Description: The Optima 450 LED® Edge-Lit Light Box is designed to be the brightest LED edge-lit light box while being the most customizable offering of its kind in the industry. The unique LED placement and advanced design delivers bright, even illumination & eliminates hot spots. Available in Stylmark’s wide variety of colors and finishes, the Optima 450 LED Edge-Lit Light Box can be wall mounted or suspended from the ceiling. Double-sided units and custom-sized units are also available.

Applications: Back-lit signage for retail environments, airports, museums, restaurants

Key Features:

- High brightness LED edge-lit lighting with even uniformity
- Independent LED lighting component enables field serviceability
- Four-sided snap frame for ease of front-loading graphic installation
- Single-sided signs available with external or internal power supply options
- ADA Compliant
- Custom-sized to order
- 2 year warranty

Dimensions¹:

Cabinet Depth:

Single-sided: 0.97" (25mm) - external power supply

Single-sided: 2-3/16" (55mm) - internal power supply

Double-sided: 3-5/32" (80mm) - internal power supply

Graphic Size:

Maximum size: 48" x 96" (all types)¹

Minimum size: 8" x 8" (external power supply)

12" x 18" (internal power supply)

Cabinet Size:

Add 1.6" (40mm) to W x H

Visual Size:

Subtract 1.6" (40mm) from W x H

Lighting Performance:

exceeds 450 f.c.²

Light Color Temperature:

6500K (5300K, 3700K by special order)

Construction Specifications:

Frame Type:

1.50" (38mm) wide snap frame with mitered corners

Frame Material:

Anodized or painted aluminum

Frame Finish:

See Stylmark Color Library

Power Specifications & Circuit Sizing:

Power Supply type:

External (option for single sided-only)

Internal (option for single sided, standard for double sided)

Voltage:

100~240VAC (50/60 Hz) – external power supply

120~277VAC (50/60 Hz) – internal power supply

Current @120VAC:

0.05A per foot of lit edge³

LED Power Consumption:

6W per foot of lit edge³ (@24VDC)

Weight: (typical)

Single-sided:

3.6 lbs/ft² (17.6 kg/m²) - external power supply

Single-sided:

6.7 lbs/ft² (32.5 kg/m²) - internal power supply

Double-sided:

10.2 lbs/ft² (49.9 kg/m²) - internal power supply

Environmental Specifications:

Protection Rating:

For indoor use only – Dry locations

Temperature Range:

60 to 104°F (16 to 40°C)

¹ Single-Sided Optima 450 light boxes with external power supplies up to 90" in length with a width from 12" to 48" are Listed to UL48-Electric Signs for US and Canada. Sizes in excess of these dimensions will require two external power supplies and do not carry a UL48 Listed mark. All units with internal power supplies will include a UL48 Listed mark.

² As measured at the center point of 24" x 36" (610mm x 915mm) unit.

³ Typical construction provides LED lighting along two longest sides of light box. Determine power consumption by multiplying the sum of the two longer sides of the light box by the power consumption per foot.

In order to continually improve our products, Stylmark reserves the right to make changes to specifications or materials without prior notice.

Sheet# 971668
Revision F (5/17)

Ordering Information:

Model:

- Single-sided (ext P.S.)
- Single-sided (int P.S.)
- Double-sided (int P.S.)

Orientation:

- Portrait
- Landscape

Dimensions (graphic):

- Height _____
- Width _____

Dimensions (outside):

- Height _____
- Width _____

Face Sheet:

- None
- Clear 0.015"
- Non-glare 0.015"
- Non-Glare 0.060"

Finish:

- Satin Natural (020)
- Satin Brass (021)
- Satin Black (023)
- Other _____

- Satin White Gold (024)
- Satin Pewter (027)
- Satin Stainless Steel (028)
- Custom _____

Mounting Type:

- Wall
- Hanging
- Pedestal
- Foot

Wiring Type:*

- Cord & Plug (grey)
- Cord & Plug (black)
- Cord & Plug (white)
- Hard Wired

Switch:*

- No Switch
- Include Switch

Color Temperatures:

- 6500K (standard)
- 5300K (special order)
- 3700K (special order)

(* - option for models with internal power supply)

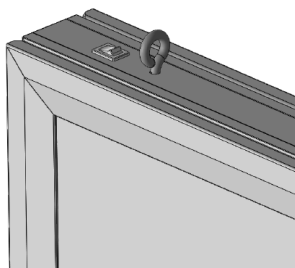
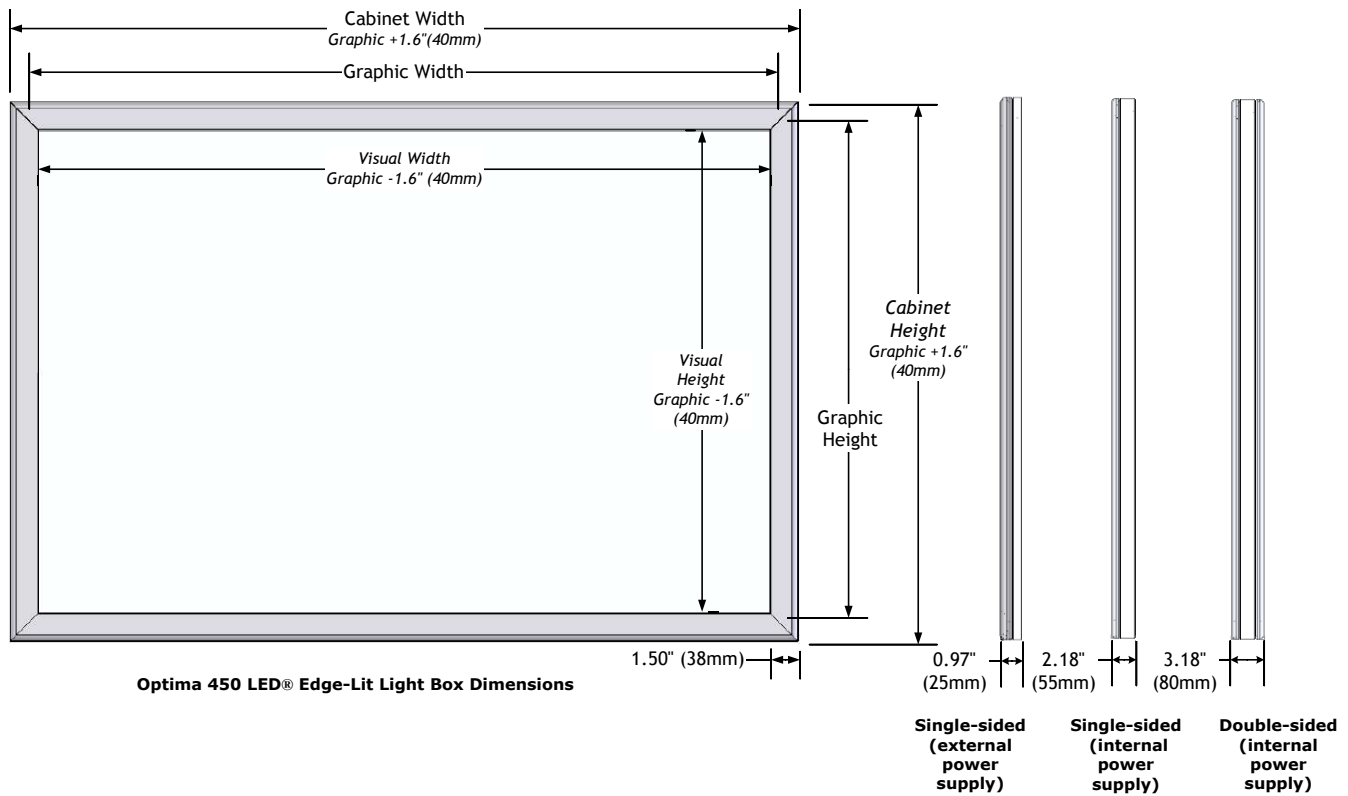

Eyelet for Ceiling Mount

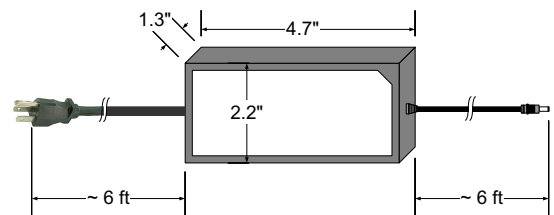

External Power Supply dimensions

Note: additional 60" cord supplied with light box

Sheet# 971668
Revision F (5/17)