



Fitting Room Extrusions & Hardware

Stylmark offers sturdy, high-quality fitting room systems designed to fit together easily and quickly allowing for rapid field installation. With the flexibility of our post-and-panel system, you can create unique, cost-effective and modular designs in numerous store areas.

Fitting Rooms

2

Fitting Rooms

Stylmark offers components and hardware that can be used to create a variety of custom fitting room configurations. Fitting room extrusions are sold in stock length material or material may be fabricated to meet your specific requirements.

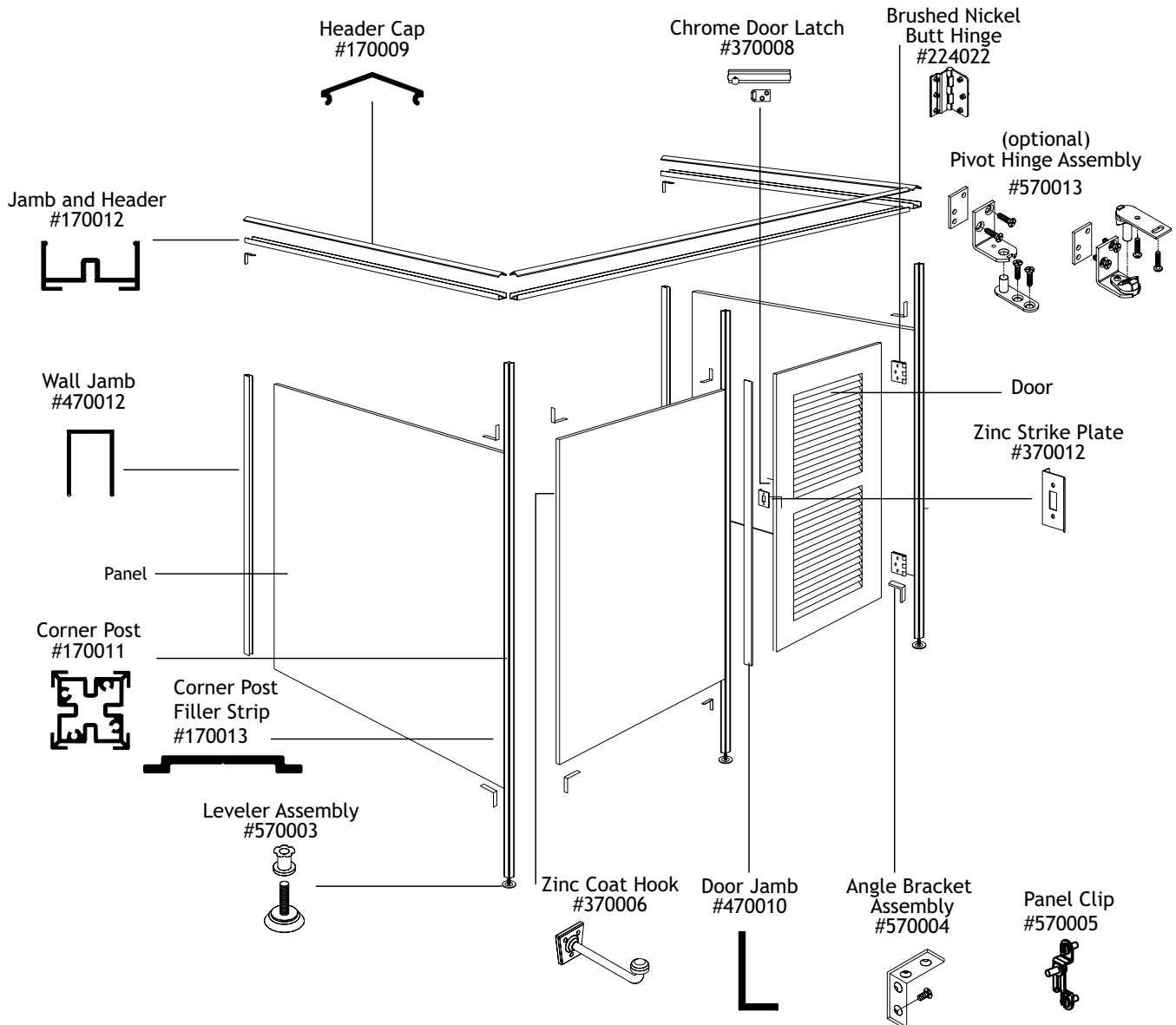

Notes: • Panel and door provided by other

Fitting Rooms

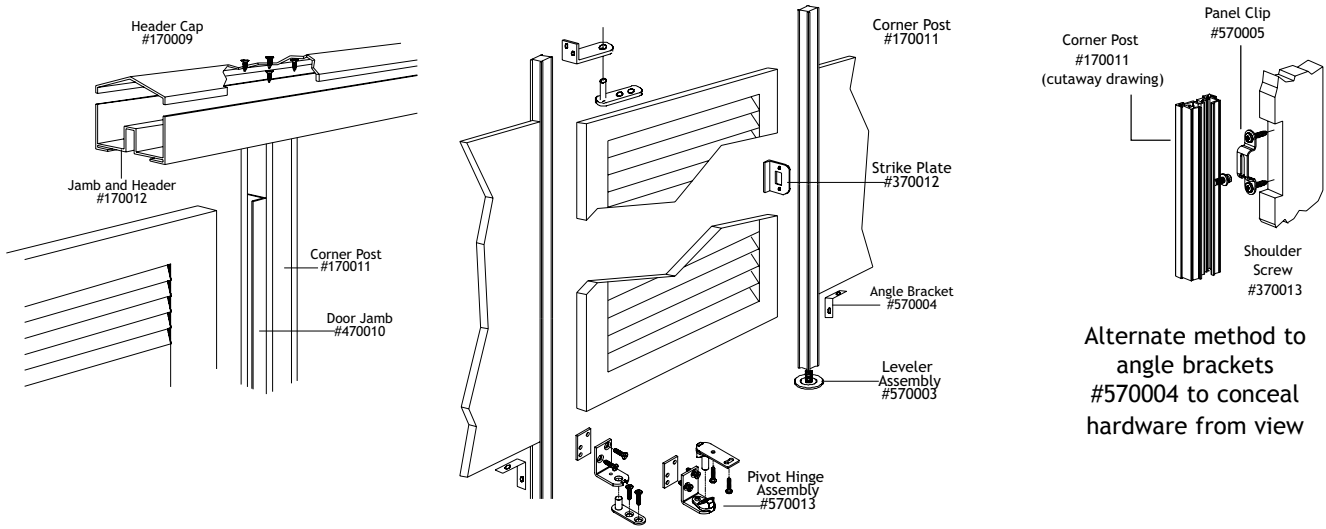

Part #170012
Jamb and Header
Stock Length = 144"

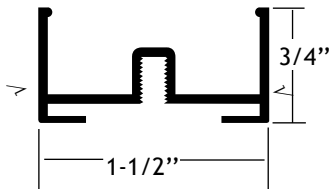

Part #170009
Header Cap
Stock Length = 144"

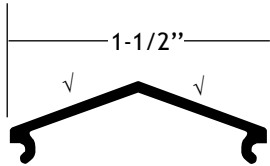

Part #170011
Corner Post
Stock Length = 84"

Part #170014
Corner Post
Stock Length = 146"

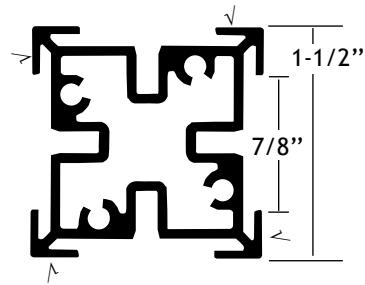

Part #470010
Door Jamb with Slots
Stock Length = 84"

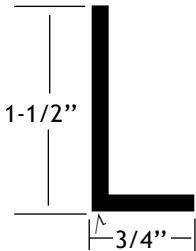

Part #470012
Wall Jamb with Holes

Part #170008
Wall Jamb without Holes
Stock Length = 144"

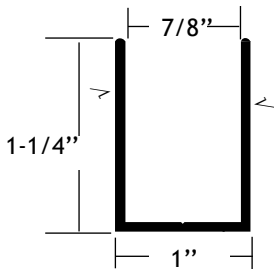

Part #170013
Corner Post
Filler Strip
Stock Length = 84"

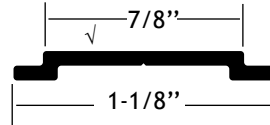

√ = finished surface

Fitting Rooms

Part #224022
Brushed Nickel Butt Hinge
Use for heavier doors.

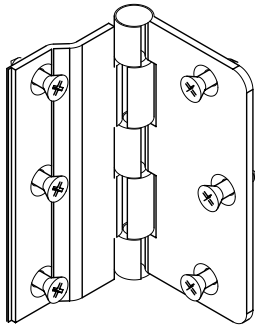

Part #570013
Brass Plated Pivot Hinge Assembly
Use for light duty or covered doors, not exceeding 35 lbs.

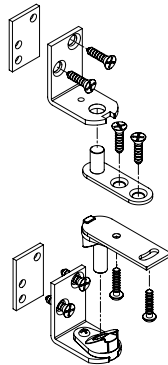

Part #570003
Leveler Assembly
Used to assure easy adjustability.

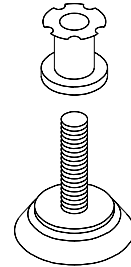

Part #570004
Angle Bracket
Bracket supports can be used to attach panels to posts. Anodized to match.
(includes bracket and two screws)

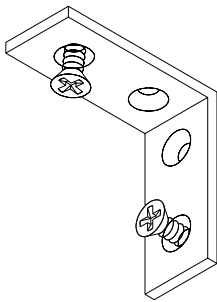

Part #570005
Panel Clip Kit
Used as an alternative method of attaching panels to posts. Includes hardware and 4 clips.

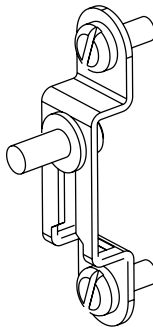

Part #370012
Zinc Strike Plate
Latches are designed for easy, secure installations. Includes screws.
Zinc plated.

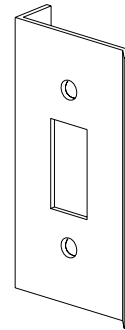

Part #370008
Chrome Door Latch

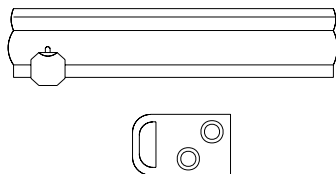

Part #370006
Zinc Coat Hook

